

RoHS compliant

REVISION DATA				
SYM	ECN	DESCRIPTION	DATE	APPROVED

NOTES:  
 Current Rating:1AMP  
 Contact Resistance:20mΩ max  
 Withstand Voltage:500V AC/DC  
 Insulation Resistance:1000MΩ min  
 Operation Temperature:-40°C to +105°C  
 Contact Material:Brass  
 Contact plating:Au or Sn Over Ni  
 Insulator Material:PA6T+30%GF(UL94V-0)

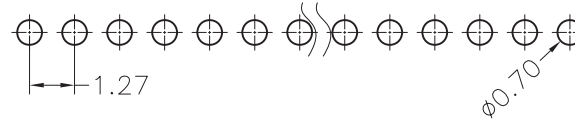
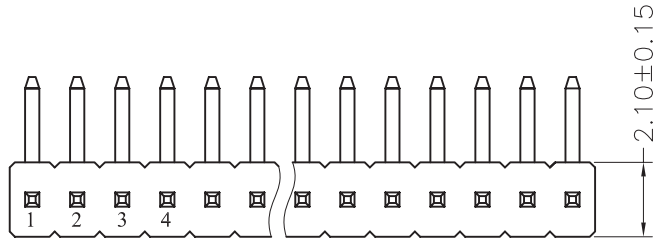

Recommended P.C.B Layout(Top Side)  
 (PCB BOARD TOLERANCE±0.05)

### HOW TO ORDER

**PC10 - S XX R XX - B - D - A - X**

No.of Pins per Row:01-50Pins

Plating Code

Package Type:  
 A:Tray  
 B:Tube  
 C:W/Cap in Tube  
 D:W/o Cap in Tape & Reel  
 E:W/Film in Tube  
 F:W/Film in Tape & Reel  
 R:With Cap in Tape & Reel  
 G:Bag

Full Gold Type	Selective Plated Type Gold Plated on Contact Area Tin Plated on Solder Area	Full Tin Type
00 : Gold Flash 01 : Gold 3u" 02 : Gold 5u" 03 : Gold 10u" 04 : Gold 15u" 05 : Gold 20u" 06 : Gold 30u"	S0: Gold Flash, Tin 100u" S1 : Gold 3u", Tin 100u" S2 : Gold 5u", Tin 100u" S3 : Gold 10u", Tin 100u" S4 : Gold 15u", Tin 100u" S5 : Gold 20u", Tin 100u" S6 : Gold 30u", Tin 100u"	T1 : Tin 100u" T2 : Tin 200u" T3 : Tin 150u" MT: Matte Tin

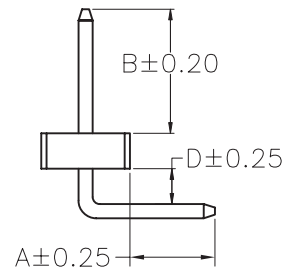
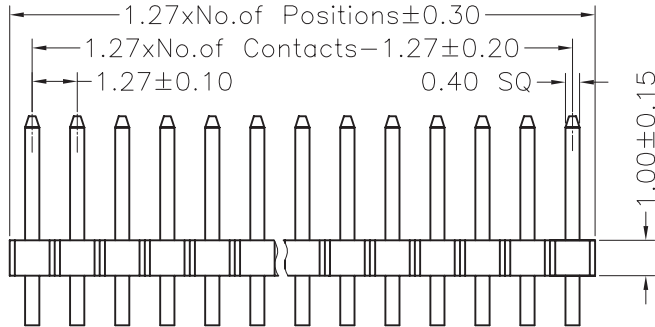

## ElectronAix

TOLERANCE: ANGLE ±3' X.XXX ±0.15 X.XX ±0.25 X.X ±0.40 X. ±0.50	PROJECTON DATE DRAWN CHECKED APPROVED	 04-14-08' JXL	TITLE: 1.27mm Pin Header Single Row 90° H=1.0 PART NO: PC10-SXXRXX-B-D-A-X REV: UNIT: SCALE: SIZE:
			A1 mm 2:1 A4